

ニップルコネクタ Hタイプ [金属]

NIPPLE CONNECTOR H TYPE [METAL BODY]

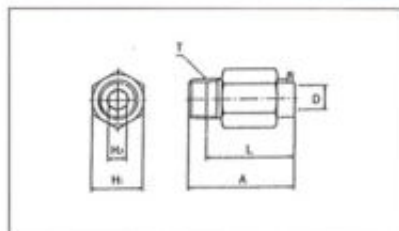

型式 Model	A	適用 チューブ外径 Tube O.D. φD	二面幅 Spanner Flats		L	ねじサイズ Thread T	挿入寸法 Tube Insert Length	外皮剥離寸法 Peeling Length for Spatter Tube
			H ₁	H ₂				
CKN-6-01H	33.4	6	14.0	4.0	29.4	R1/8	28.5	24.5
CKN-6-02H	33.4		14.0	4.0	27.4	R1/4		
CKN-6-03H	33.4		17.0	4.0	27.0	R3/8		
CKN-8-01H	37.4	8	17.0	5.0	33.4	R1/8	28.5	24.5
CKN-8-02H	35.4		17.0	6.0	29.4	R1/4		
CKN-8-03H	32.4		17.0	6.0	26.0	R3/8		
CKN-10-01H	41.9	10	19.0	5.0	37.9	R1/8	32.0	27.0
CKN-10-02H	39.9		19.0	6.0	33.9	R1/4		
CKN-10-03H	38.9		19.0	8.0	32.5	R3/8		
CKN-10-04H	35.9		21.0	8.0	27.9	R1/2		
CKN-12-02H	47.4	12	21.0	7.0	41.4	R1/4	35.0	30.0
CKN-12-03H	44.9		21.0	9.0	38.5	R3/8		
CKN-12-04H	45.4		21.0	9.0	37.4	R1/2		

エルボコネクタ Hタイプ [金属]

ELBOW CONNECTOR H TYPE [METAL BODY]

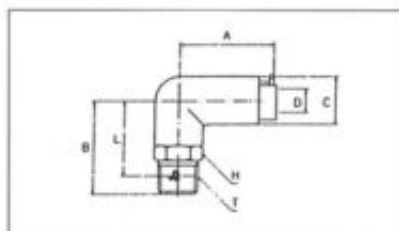

型式 Model	A	B	φC	適用 チューブ外径 Tube O.D. φD	二面幅 Spanner Flats H	L	ねじサイズ Thread T	挿入寸法 Tube Insert Length	外皮剥離寸法 Peeling Length for Spatter Tube
CKL-6-01H	30.9	27.0	14.0	6	12.0	23.0	R1/8	28.5	24.5
CKL-6-02H		30.0			14.0	24.0	R1/4		
CKL-6-03H		31.0			17.0	24.6	R3/8		
CKL-8-01H	32.4	28.0	16.0	8	14.0	24.0	R1/8	28.5	24.5
CKL-8-02H		31.0			14.0	25.0	R1/4		
CKL-8-03H		32.0			17.0	25.6	R3/8		
CKL-10-01H	35.9	28.0	18.0	10	17.0	24.0	R1/8	32.0	27.0
CKL-10-02H		31.0			17.0	25.0	R1/4		
CKL-10-03H		32.0			17.0	25.6	R3/8		
CKL-10-04H		36.0			19.0	28.0	R1/2		
CKL-12-02H	39.4	35.0	21.0	12	19.0	29.0	R1/4	35.0	30.0
CKL-12-03H		36.0			19.0	29.6	R3/8		
CKL-12-04H		39.0			21.0	31.0	R1/2		

ユニオンティ Hタイプ [金属]

UNION TEE H TYPE [METAL BODY]

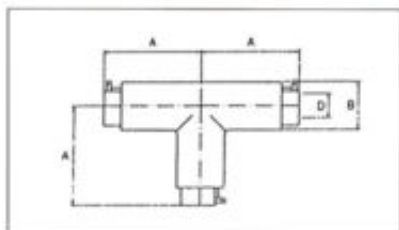

型式 Model	A	φB	適用チューブ外径 Tube O.D. φD	挿入寸法 Tube Insert Length	外皮剥離寸法 Peeling Length for Spatter Tube
CUT-6-00H	63.8	14.0	6	28.5	24.5
CUT-8-00H	65.8	16.0	8		
CUT-10-00H	74.8	18.0	10	32.0	27.0
CUT-12-00H	82.8	21.0	12	35.0	30.0