

Sleeves and Vacuum Pickups

■ For DLV7100/7200/8100/8200-□J□ series

Vacuum Pickup

DLP7000 (for DLV7100/7200/8100/8200-□J□ Series Electric Screwdrivers)

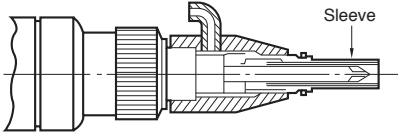

Standard Set

| | |
|--------------------------|------------------------------------|
| Vacuum Pickup (Part No.) | DLP7000 (TD00344) |
| Accessories | DLS3223 × 1 pc. DLS3225 × 1 pc. |

Sleeve DLS3000 series (Metal)

Unit: mm

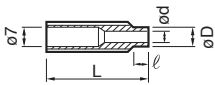

| Sleeve | | | | | | Bit | |
|----------|---------|-----|----|----|----|----------------|--|
| Part No. | Model | ød | øD | ℓ | L | | |
| TD00364 | DLS3222 | 5.6 | 7 | 5 | 34 | No.1 × 5 × 70 | |
| TD05024 | DLS3223 | 6.1 | 9 | — | | No.2 × 6 × 70 | |
| TD00365 | DLS3224 | 6.4 | 9 | | | | |
| TD00366 | DLS3225 | 7.1 | 9 | | | | |
| TD00367 | DLS3226 | 4.6 | 7 | 18 | 65 | No.1 × 4 × 100 | |
| TD00368 | DLS3227 | 5.1 | 7 | | | | |
| TD00369 | DLS3228 | 5.6 | 7 | | | | |
| TD00370 | DLS3229 | 6.1 | 9 | — | | No.1 × 5 × 100 | |
| TD00371 | DLS3230 | 6.4 | 9 | | | | |
| TD00372 | DLS3231 | 7.1 | 9 | | | | |

Phillips Head
(No. × d × L)

■ For DLV7100/7200/8100/8200 series
DLV30/45/70 series

Vacuum Pickup

DLP7400

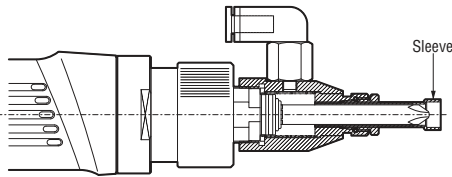

Standard Set

| | | |
|--------------------------|-----------------------------|---|
| Vacuum Pickup (Part No.) | DLP7400 (TD07285) | DLP7400 for high torque (TD07286) |
| | OD 5mm Hex. Shank | OD 6.35mm Hex. Shank |
| Accessories | DLS3223 × 1 pc. | DLS4220 × 1 pc. |
| | DLS3225 × 1 pc. | DLS4221 × 1 pc. |

Sleeve DLS4000 series (Metal)

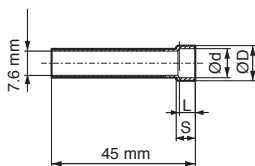

| Sleeve | | | | | | Bit | Phillips Head (No. × d × L) ⊕ |
|---------|----------|----------|----------|---------|---------|-------|----------------------------------|
| Model | Part No. | ød mm | øD mm | L mm | S mm | | |
| DLS4220 | TD08001 | 9.1 | 11 | 5 | 6 | NK 35 | No.1 × 7 × 75 |
| DLS4221 | TD08002 | 10.6 | 12.5 | 5.5 | 7 | | No.2 × 7 × 75 |
| | | | | | | | No.3 × 7 × 75 |