

MAF400 series

AIR UNITS (Filter)



mindman



Symbol

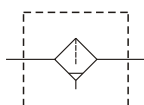

Specification

Model	MAF400		
Bore No.	8A	10A	15A
Port size	1/4	3/8	1/2
Medium	Air		
Operating pressure range (※1.2.)	0.05~1 MPa		
Proof pressure	1.5 MPa		
Ambient temperature	-5~+60℃ (No freezing)		
Filter element	Standard: 40 μm Option: 5 μm		
Max. flow rate (※3) ℓ/min.(ANR)	1500	2000	2200
Option	Bracket		
Weight	550 g		

※1. Standard unit contains semi-auto-drain function when operating pressure below 0.05 MPa.

※2. Choose auto-drain FMRF300, the pressure range is 0.15 ~ 1 MPa.

※3. Flow is at pressure P=0.7 MPa with pressure drop ΔP=0.03 MPa.

Order example

MAF400 - 8A - D - □ - □ - □

MODEL

BORE SIZE

8A: 1/4
10A: 3/8
15A: 1/2

FILTER ELEMENT
Blank: 40 μm
5μ: 5 μm

D: auto drain valve (FMRF 300)

B: bracket

PORT THREAD

Blank: Rc thread
G: G thread
NPT: NPT thread

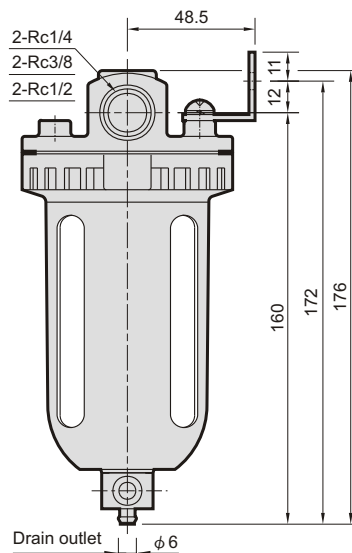
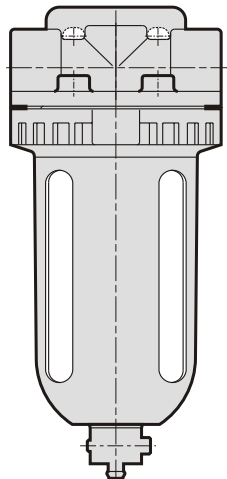
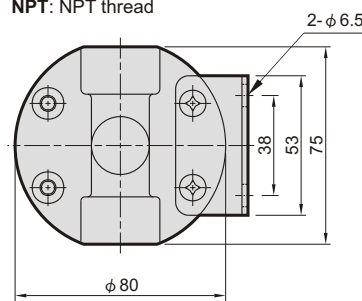

mindman