

Specification

Model	MCRD					
Tube I.D. (mm)	10	15	20	30	40	
Vane type	Single vane					
Port size	M3×0.5		M5×0.8			
Medium	Air (Not required)					
Max. operating pressure	0.7 MPa			1.0 MPa		
Min. operating pressure	0.2 MPa	0.15 MPa				
Proof pressure	1.05 MPa			1.5 MPa		
Ambient temperature	+5~+60℃					
Allowable kinetic energy (J) ※1	0.00015	0.001	0.003	0.02	0.04	
		0.00025	0.0004	0.015	0.03	
Load (N)	Radial	15	15	25	30	60
	Axial	10	10	20	25	40
Rotation time adjustment range (s/90°) ※2	0.03~0.3			0.04~0.3	0.07~0.5	
Rotary angle range	0□~175°					
Rotary angle	90□, 180°, 270°					

Order example

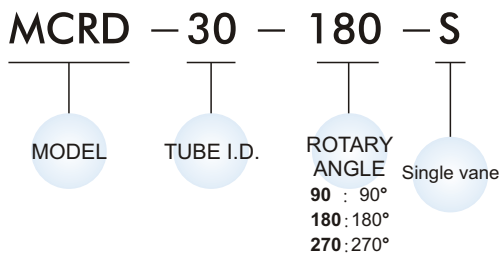

※1. The kinetic energy on upper row is for rubber bumper, on row is for no bumper.

※2. Please operate the gripper within its adjustment range as specified. Sticking will occur when the operating speed has exceeded the limit value (0.3s/90°), it will cause the gripper to fail when operating.

Torque diagram

● MCRD-10

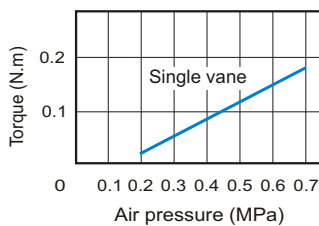

● MCRD-15

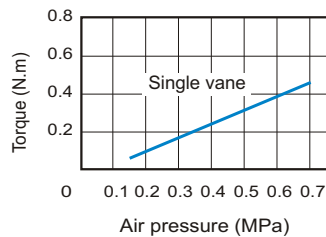

● MCRD-20

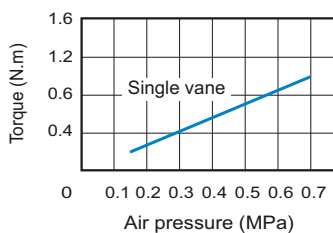

● MCRD-30

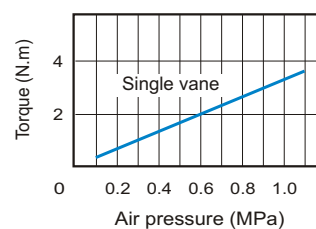

● MCRD-40

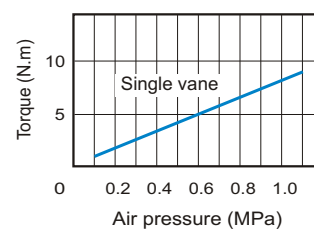

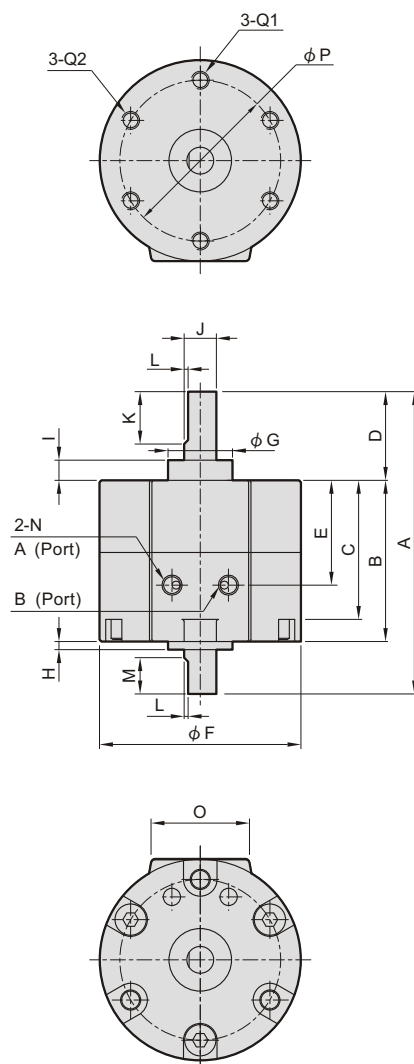

Code Tube I.D.	A	B	C	D	E	F	G	H	I	J	K	L	M	N	O	P	Q1	Q2
10	37	15	14	14	9.5	29	9	1	3	4	9	0.5	5	M3	19.8	24	—	M3 (6)
15	47	20	19	18	10	34	12	1.5	4	5	10	0.5	6	M3	21	29	M3 (5)	M3 (10)
20	59	29	24.5	20	13	42	14	1.5	4.5	6	10	0.5	7	M5	22	36	M4 (7.5)	M4 (13.5)
30	75	40	34.5	22	14	50	16	2	5	8	12	1.0	8	M5	24	43	M5 (10)	M5 (18)
40	90	45	39.8	30	20	63	25	4.5	6.5	10	20	1.5	9	M5	30	56	M5 (10)	M5 (16)