

MACHINE-FITTING TYPE AIR CUTTERS

Optimum for mounting
on automatic machine !

● MR ~ M Type

● MP ~ M Type



MR20M



MP35AM

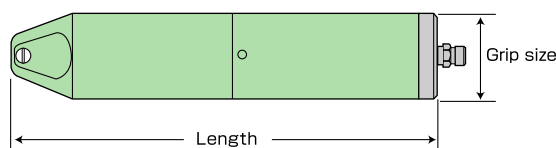
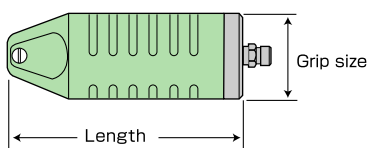

★ Refer to P.(1&2) for detailed information of cutting blades.

Model No.	Length Weight	Grip size Air consumption	Power (approx.) Air pressure	Blade No. * Carbide tipped	Cutting capacity ϕ mm					
					Steel wire	Copper wire	Piano wire	Crimp-ing	Plastics Soft	Plastics Hard
MR3M	101 mm	ϕ 20 mm	265 N	S20, S20S, EP20, CR20	0.5	0.8	—	—	—	—
	70 g	35 cm ³ /Stroke	0.4~0.5 MPa	* Z20, Z20S, ZEP20, ZCR20	0.5	0.8	0.2	—	—	—
				F10, F10S, FD10	—	—	—	—	1.0	—
MR5M	84 mm	ϕ 30 mm	390 N	S2, S2S, EP2, CR2	0.5	1.0	—	—	—	—
	100 g	64 cm ³ /Stroke	0.4~0.5 MPa	* Z2, Z2S, ZEP2, ZCR2	0.5	1.0	0.3	—	—	—
				F1, F1S, FD1	—	—	—	—	2.0	—
MR10M	105 mm	ϕ 36 mm	580 N	S4, S4S, EP4, CR4	1.0	1.6	—	—	—	—
	160 g	116 cm ³ /Stroke	0.4~0.5 MPa	* Z4, Z4S, ZEP4, ZCR4	1.0	1.6	0.5	—	—	—
				F3, F3S, FD3, F3LS	—	—	—	—	4.0	2.6
MR20M	121 mm	ϕ 45 mm	1,370 N	S5, S5S, P6, EP6, CR6	2.0	2.6	—	—	—	—
	270 g	230 cm ³ /Stroke	0.5~0.6 MPa	* Z6, Z6S, ZEP6, ZCR6	2.0	2.6	1.0	—	—	—
				F5, F5S, FD5, F5LS	—	—	—	—	7.0	5.0
MR30AM	157 mm	ϕ 56 mm	2,740 N	S7P, S7PS, P8P, EP10P, CR8P	2.8	3.3	—	—	—	—
	470 g	584 cm ³ /Stroke	0.5~0.6 MPa	* Z8P, Z8PS, ZEP10P, ZCR8P	2.8	3.3	1.2	—	—	—
				F9P, F9PS, FD9P	—	—	—	—	10.0	6.5
MR50AM	215 mm	ϕ 75 mm	4,700 N	S120, S120S, P120, EP120, CR120	4.5	5.5	—	—	—	—
	1,180g	1,170cm ³ /Stroke	0.5~0.6 MPa	* Z120, Z120S, ZEP120, ZCR120	4.5	5.5	1.6	—	—	—
				F120	—	—	—	—	11.0	8.0
MR50FM	173 mm 1,040g	ϕ 75 mm 1,100cm ³ /Stroke	4,100 N 0.5~0.6 MPa	F9PF, FD9PF	—	—	—	—	12.0	6.5
MP25M	170 mm	ϕ 45 mm	1,560 N	S250, S250S, CR250	1.8	2.4	—	—	—	—
	450 g	508 cm ³ /Stroke	0.5~0.6 MPa	F250, F250S, FD250	—	—	—	—	8.0	5.0
MP25AM	208 mm	ϕ 45 mm	1,960 N	S5, S5S, P6, EP6, CR6	2.0	2.6	—	—	—	—
	480 g	400 cm ³ /Stroke	0.4~0.5 MPa	* Z6, Z6S, ZEP6, ZCR6	2.0	2.6	1.0	—	—	—
				F5, F5S, FD5, F5LS	—	—	—	—	7.0	5.0
MP250M	216 mm	ϕ 45 mm	2,740 N	S7P1, S7P1S, P8P1, EP10P1, CR8P1	3.2	4.0	—	—	—	—
	510 g	508 cm ³ /Stroke	0.5~0.6 MPa	* Z8P1, ZEP10P1, ZCR8P1,	3.2	4.0	1.2	—	—	—
				F9P1, F9P1S, FD9P1	—	—	—	—	8.0	6.5
MP35AM	249 mm	ϕ 56 mm	4,410 N	S7P, S7PS, P8P, EP10P, CR8P	4.0	4.8	—	—	—	—
	790 g	956 cm ³ /Stroke	0.5~0.6 MPa	* Z8P, Z8PS, ZEP10P, ZCR8P	4.0	4.8	1.2	—	—	—
				F9P, F9PS, FD9P	—	—	—	—	13.0	6.5
MP55AM	348 mm	ϕ 75 mm	7,740 N	S120, S120S, P120, EP120, CR120	6.0	7.0	—	—	—	—
	2,000g	2,670cm ³ /Stroke	0.5~0.6 MPa	* Z120, Z120S, ZEP120, ZCR120	6.0	7.0	2.0	—	—	—
				F120	—	—	—	—	11.0	8.0

MACHINE-FITTING TYPE

AIR CUTTERS

● MR~MG, MP~MG Type

NO TOOL IS NEEDED FOR BLADE REPLACEMENT !

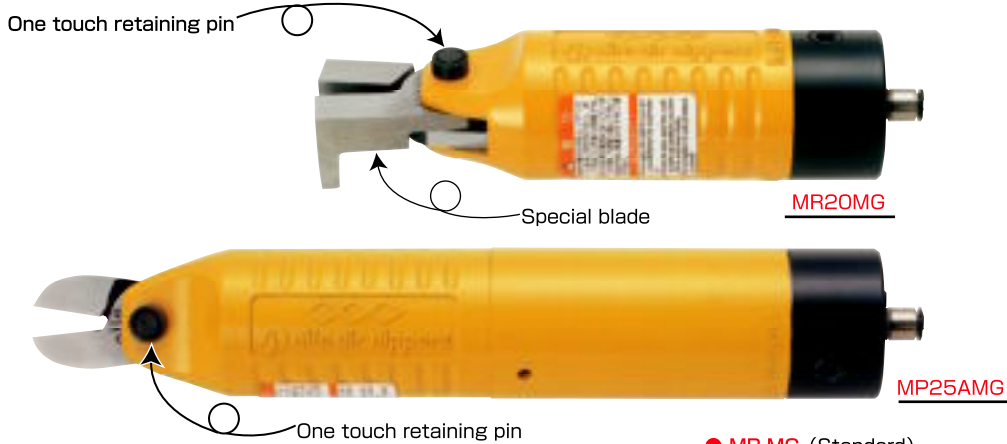

- ◆ Blade can be replaced easily and quickly.
- ◆ Blade opening-angle can be adjusted.

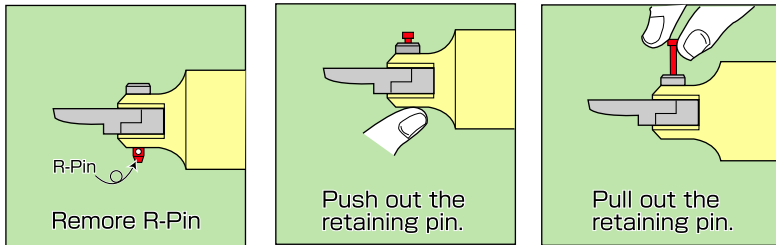

◎ Be sure to secure Retaining Pin with R-Pin attached when Retaining Pin is likely to suffer some drawing-out power or shock. (R-Pin is designed for easy removal.)

● MR-MG (Standard)

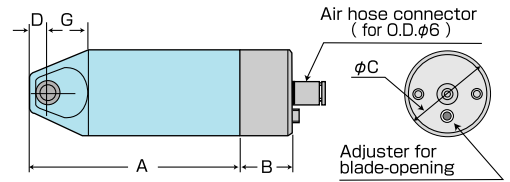

● MP-MG (Heavy-duty)

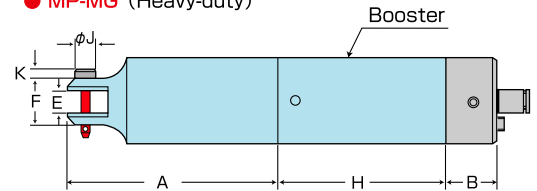

● MR~MT Type

NO TOOL IS NEEDED FOR BLADE REPLACEMENT !

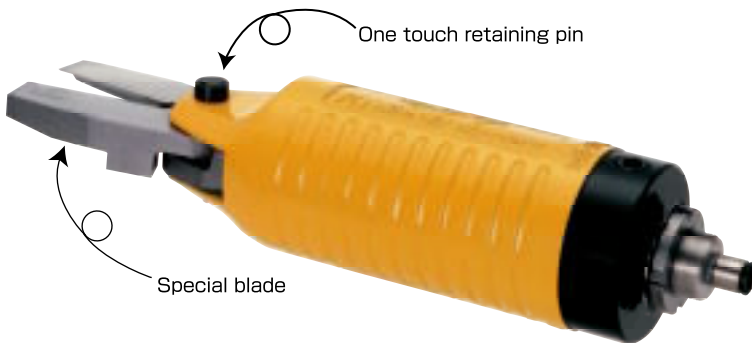

◎ All cutting blades for MR-series can be applicable in common.

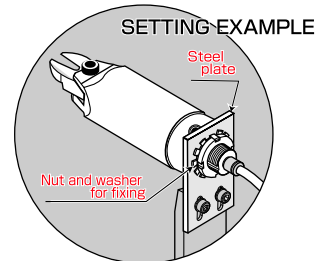

● MR-MT

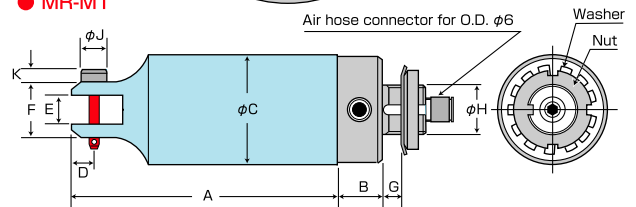

Model No.	Weight		Power (approx.)		Blade No.	Cutting capacity ϕ mm		
	Air consumption		Air pressure			Steel wire	Copper wire	Plastics
MR20MG	338 g	230 cm ³ /Stroke	1,370 N	0.5~0.6 MPa	F5, F5S S5, S5S	—	—	7.0
MP25AMG	560 g	400 cm ³ /Stroke	1,960 N	0.4~0.5 MPa	F5, F5S S5, S5S	—	—	7.0
MR30AMG	597 g	584 cm ³ /Stroke	2,740 N	0.5~0.6 MPa	F9P, F9PS S7P, CR8P	—	—	10.0
MP35AMG	924 g	956 cm ³ /Stroke	4,410 N	0.5~0.6 MPa	F9P, F9PS S7P, CR8P	—	—	13.0
MR20MT	317 g	230 cm ³ /Stroke	1,370 N	0.5~0.6 MPa	F5, F5S S5, S5S	—	—	7.0
MR30AMT	537 g	584 cm ³ /Stroke	2,740 N	0.5~0.6 MPa	F9P, F9PS S7P, CR8P	—	—	10.0

Dimensions (mm)										
Model No.	A	B	C	D	E	F	G	H	J	K
MR20MG	109	27	45	9	12	23	22	—	11	5
MP25AMG	109	27	45	9	12	23	22	87	11	5
MR30AMG	145	27	56	10	17	30	30	—	12	5
MP35AMG	145	27	56	10	17	30	30	92	12	5
MR20MT	109	18	45	9	12	23	10	20	11	5
MR30AMT	145	18	56	10	17	30	10	20	12	5

Blade No.				Dimensions (mm)		
Blade No.	a	b	c			
F5, F5S	35	15	8.5	● F, S Type		
S5, S5S	35	17	6.5	● F-S, S-S Type		
F9P	65	38	15.0	● CR Type		
F9PS	65	37	15.0			
S7P	43	20	7.0			
CR8P	43	20	7.0			