

"SNIP"

MULTI-PURPOSE QUICK, CLEAN CUTTERS.

Designed for one-hand operation. light in weight and compact.

Cutting nylon hose, rubber hose, soft cable wire, prefabricated timbers, plastic channel, leather belt, etc.

■ **SX5** Slim type



■ **SX10** Heavy-duty type



Plastic channels such as telephone wire protectors can also be cut at any desired angle.

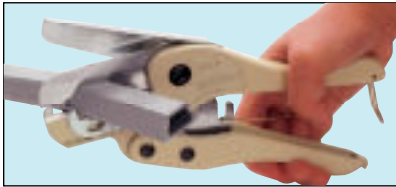

● Prefabricated timbers

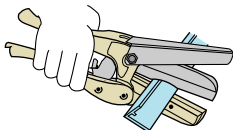

● Soft cable wire

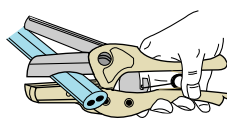

● Rubber nylon hose

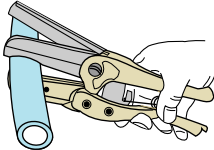

● Handicraft timber and bamboo of max $\phi 38\text{mm}$ o.d.

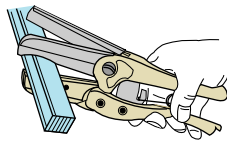

Pruning Max $\phi 38\text{mm}$ o.d.

LONG BLADE MULTI-PURPOSE

■ **SX 20**

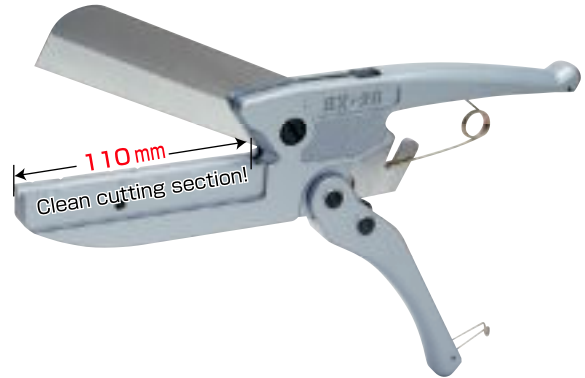

(SX25 is recommended to cut hard and wide objects-see next page.

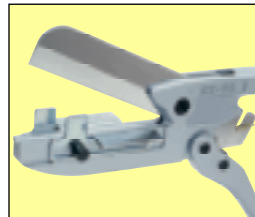

An attachment is available, for right and 45° angle cutting.



Straight cutting of nylon hoses.



Cutting of flat ribbon cable.



Edge cutting of panel carpet.

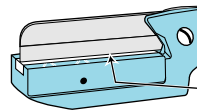

Cutting objects with the long blade edge thoroughly contacted.

Model No.	Overall length	Weight	Blade length	Blade No.
SX5	195mm	140g	50mm	X5
SX10	210mm	310g	65mm	X10
SX20	285mm	535g	110mm	X20

FOR CUTTING PLASTIC SURFACE RACEWAY

DX 71



Cutting plastic surface raceways (45°,90°)



Remove the attachment for cutting plastic ducts.



Model No.	Overall length	Weight	Blade length	Blade No.
DX71	235mm	360g	70mm	X70