

For Air

Super Duster Cupla

Air line coupling with air blow function

Working pressure

1.0
1.0 MPa
(10 kgf/cm²)

Valve structure



One-way shut-off

Applicable fluid



Air

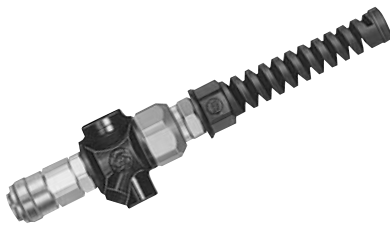

Photo shows simulated air flow.

Three functions in one: connection, air blow, hose twist release! Dust blow without detaching the tool!

- Super Cupla comes with compact air blow function.
- Not only standard quick connects/disconnects function between pneumatic tools and air lines, but also has air blow feature that improves job efficiency to remove dust and swarf with tool still connected.
- Cut out much of the tedious part of your work; such as changing to or picking up an air gun.
- Ball bearing swivel mechanism prevents hose twist and relieves tension on operator's hands.
- Large light-touch switch button adopted for easy operation, even when wearing gloves.
- Also simple is routine water drain from air line before starting daily work.

Specifications

Body material	Body : Aluminum, Cupla : Steel			
Size	For ø6.5 mm x ø10mm polyurethane hose			
Working pressure MPa (kgf/cm ²)	1.0 {10}			
Pressure resistance MPa (kgf/cm ²)	1.5 {15}			
Seal material	Seal material	Mark	Working temperature range	Remarks
Working temperature range	Nitrile rubber	NBR (SG)	-5°C~+60°C	Standard material

Tightening Torque Range

N·m {kgf·cm}

5~6 {51~61}

Flow Direction

Fluid must run from socket to plug.



Interchangeability

Can be connected to Super Cupla plugs.

Suitability for Vacuum

Not suitable for vacuum application in either connected or disconnected condition.

Pressure - Flow Characteristics

[Test conditions] • Fluid : Air • Temperature : Room temperature

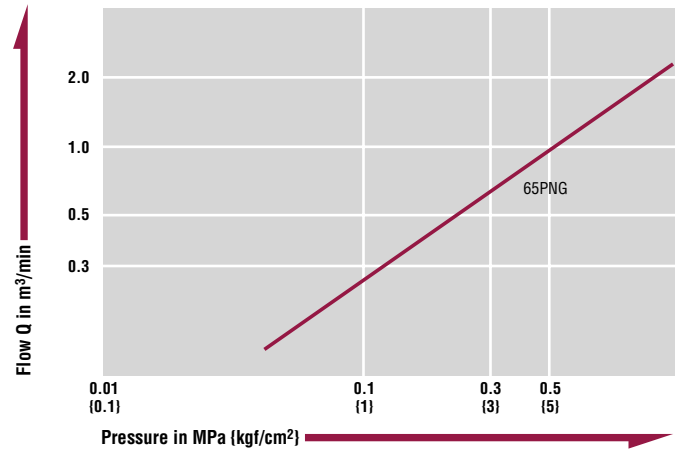

Models and Dimensions

WAF : WAF stands for width across flats.

Socket PNG type (For hose with hose guard nut connection)

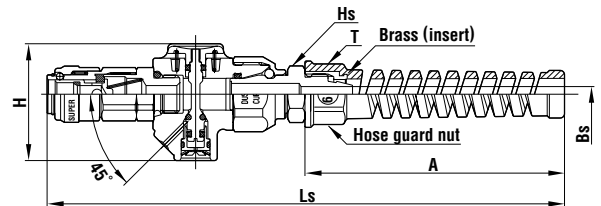

Model	Application (Hose)	Mass (g)	Dimensions (mm)					
			Ls	A	H	øBs	HS(WAF)	T(WAF)
SDS-65PNG	ø6.5 mm x ø10 mm	158	179.4	90	40.5	5.3	Hex.17	Hex.19