

For Vacuum

Screw Cupla

PCS Type

For vacuum and pressure testing

Working pressure



3.0 MPa
(31 kgf/cm²)

Valveless

Applicable fluids



Inert gas
vacuum



Air



Water



Hydraulic oil



Direct connection on to the male thread part greatly improves working efficiency! Equipped with stopper for safety.

- Connects directly to a parallel male thread (unified thread).
- Just push it onto the male threaded part for connection. When connected, its locking claws securely grip the threaded part.
- Equipped with safety stopper mechanism that prevents accidental disconnection while in use.
- Since the tedious job of screw tightening is eliminated, the time required for connection work is minimized.

Specifications

Body material	Steel (some parts are of stainless steel)			
Size	For 7/16-20UNF, 5/8-18UNF, 3/4-16UNF, 7/8-14UNF, or 11/16-14UNS			
Working pressure MPa (kgf/cm ²)	3.0 (31)			
Pressure resistance MPa (kgf/cm ²)	4.5 (46)			
Seal material Working temperature range	Seal material	Mark	Working temperature range	Remarks
	Chloroprene rubber	CR (C308)	-20°C~+80°C	Standard material
	Hydrogenated nitrile rubber	HNBR (H708)	-20°C~+120°C	Available on request

Application example

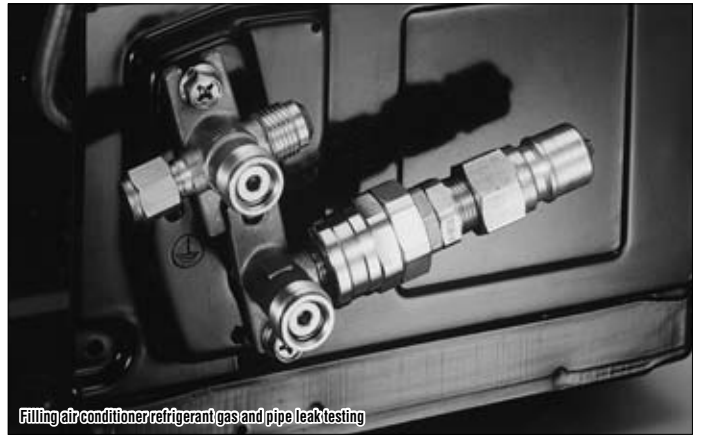

Filling air conditioner refrigerant gas and pipe leak testing

Models and Dimensions

WAF : WAF stands for width across flats.

Application Work

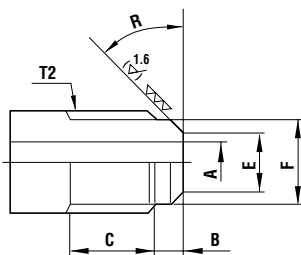

Dimensions (mm)

øE	øF	R	B	C	øA	T ₂
5.5	8.7	45°	3.7	8.3 or more	4.8	7/16-20UNF
8	13.5	45°	4.8	8.2 or more	7	5/8-18UNF
11	16	45°	6	10 or more	10	3/4-16UNF
13.5	19	45°	6	14 or more	12	7/8-14UNF
18	24	45°	6	20 or more	16	11/16-14UNS

Socket PCS type (Male thread)

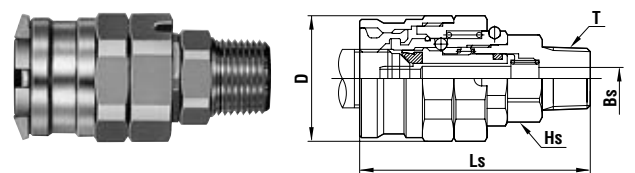

Model	Mountable Thread Size	Type	Application	Mass (g)	Dimensions (mm)				
					Ls	øD	øBs	Hs(WAF)	T
PCS-7U	7/16-20UNF	PCS-7U-2	Rc 1/4	127	55	28	4	Hex.19	R 1/4
		PCS-7U-3	Rc 3/8	133					R 3/8
PCS-10U	5/8-18UNF	PCS-10U-2	Rc 1/4	191	63	34	7	Hex.21	R 1/4
		PCS-10U-3	Rc 3/8	196					R 3/8
PCS-12U	3/4-16UNF	PCS-12U-2	Rc 1/4	299	71.5	40	7	Hex.24	R 1/4
		PCS-12U-3	Rc 3/8	305					R 3/8
PCS-14U	7/8-14UNF	PCS-14U-2	Rc 1/4	359	75.5	43	7	Hex.27	R 1/4
		PCS-14U-3	Rc 3/8	365					R 3/8
PCS-17U	11/16-14UNS	PCS-17U-3	Rc 3/8	—	75	51	11	Hex.35	R 3/8