

For High Purity Chemicals

Semicon Cupla

SP Type

For semiconductor manufacturing production installation

Working pressure



0.2 MPa
(2 kgf/cm²)

Valve structure



Two-way shut-off

Applicable fluids



High purity
chemicals



Water



Gas



Air

General purpose type with stainless steel body and rubber seal.
Electro-polished body for enhanced corrosion resistance.

- Body and valve springs are stainless steel (SUS304). Body is electro-polished for enhanced corrosion resistance.
- Seal materials can be selected to suit your fluid and application, to flexibly comply with your semiconductor production process requirements.
- All components are cleaned, assembled, inspected, and then packed in a clean room.
- No grease is applied to the seal material.
- Each plug comes with a dust cap.
- Stainless steel SUS316 body and valve springs are available as made-to-order products.



Specifications

Body material		Electropolished stainless steel (SUS304)		
Size (Thread)		1/8", 1/4", 3/8", 1/2", 3/4", 1" 1/8-27NPT, 1/4-18NPT, 19/32-18UNS		
Working pressure	MPa	0.2		
	kgf/cm²	2		
	bar	2		
	PSI	29		
Seal material Working temperature range	Seal material	Mark	Working temperature range	Remarks
	Fluoro rubber	FKM (X-100)	0°C to +50°C	Standard material
	Ethylene-propylene rubber	EPDM (EPTS)	0°C to +50°C	Standard material
	Perfluoroelastomer	P	0°C to +50°C	Standard material
	Kalrez	KL	0°C to +50°C	Standard material

Min. Cross-Sectional Area

(mm²)

Model	1SP	2SP	3SP	4SP	6SP	8SP
Min. cross-sectional area	13	17	48	64	83	192

Flow Rate – Pressure Loss Characteristics

[Test conditions] • Fluid : Water • Temperature : 20°C ± 5°C

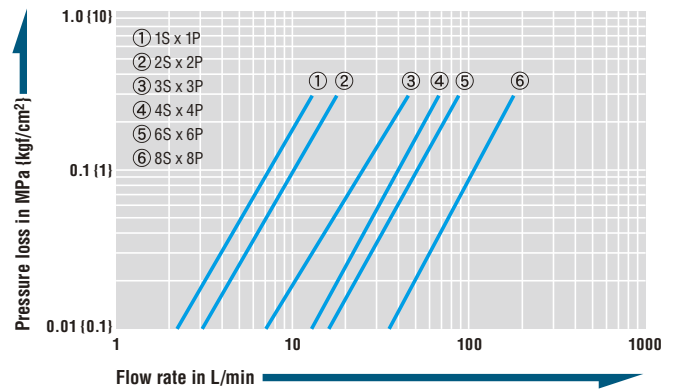

Interchangeability

Socket and plug in the same size can be connected regardless of their end configurations.

Models and Dimensions

WAF : WAF stands for width across flats.

Plug Female thread

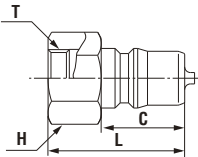

Model	Container capacity	Mass (g)	Dimensions (mm)			
			L	C	H(WAF)	T(Female thread)
1P-304	For 10L to 20L	19	29	19	*Hex.14	Rc 1/8
1P-304-NPT	For 10L to 20L					1/8-27NPT
1P-304-UNS	For 10L to 20L	34	33	19	Hex.21	19/32-18UNS
2P-304	For 10L to 20L					Rc 1/4
2P-304-NPT	For 10L to 20L	35	36	22	*Hex.17	1/4-18NPT
2P-304-UNS	For 10L to 20L	41	36	22	Hex.21	19/32-18UNS
3P-304	For 100L to 200L	60	40	25	*Hex.21	Rc 3/8
4P-304	For 100L to 200L	115	44	28	*Hex.29	Rc 1/2
6P-304	For 100L to 200L	216	52	36	*Hex.35	Rc 3/4
8P-304	For 100L to 200L	352	62	40	*Hex.41	Rc 1

* Above are the dimensions of SUS304.

* The appearance of SUS304 and 316 bodies is different.

Socket Female thread

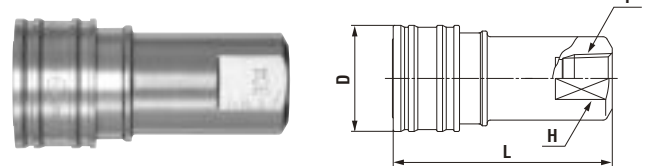

Model	Container capacity	Mass (g)	Dimensions (mm)			
			L	øD	H(WAF)	T(Female thread)
1S-304	For 10L to 20L	82				Rc 1/8
1S-304-NPT	For 10L to 20L	84	48	24	14	1/8-27NPT
2S-304	For 10L to 20L					Rc 1/4
2S-304-NPT	For 10L to 20L	138	58	28	19	1/4-18NPT
3S-304	For 100L to 200L	204	65	35	21	Rc 3/8
4S-304	For 100L to 200L	424	72	45	29	Rc 1/2
6S-304	For 100L to 200L	708	88	55	35	Rc 3/4
8S-304	For 100L to 200L	1081	102	65	41	Rc 1

Before use, please be sure to read "Safety Guide" described at the end of this book and "Instruction Sheet" that comes with the products.