

For High Purity Chemicals

Semicon Cupla

SCT Type

For semiconductor manufacturing equipment

Working pressure

0.2
MPa
(2 kgf/cm²)

Valve structure



Two-way shut-off

Applicable fluids



High purity
chemicals



Water



Gas



Air

Polytetrafluoroethylene (PTFE) is utilised for the body.

- Polytetrafluoroethylene (PTFE) body gives excellent resistance to chemicals.
- Both socket and plug have built-in automatic shut-off valves that prevent fluid from outflowing when disconnected.
- No dissolution of metal ions from part in contact with liquid ensures excellent reliability.
- All components are cleaned, assembled, inspected and then packed in a clean room.
- Appropriate model can be selected from a wide variety of sizes to suit your application / fluid.
- Optional keyway lock to prevent incorrect connection.
10 keyway patterns are available.



Specifications

Body material	Polytetrafluoroethylene (PTFE)				
Size (Thread)	1/4", 3/8", 1/2", 3/4", 1" 1/4-18NPT, 3/8-18NPT, 1/2-14NPT, 3/4-14NPT, 1-11.5NPT				
Working pressure	MPa	0.2			
	kgf/cm ²	2			
	bar	2			
	PSI	29			
Seal material	Socket	Seal material	Mark	Working temperature range	Remarks
Working temperature range	O-ring	FEP-covered fluoro rubber	—	+5°C to +50°C	Standard material
	Valve	Fluoropolymer resin			

Min. Cross-Sectional Area

(mm²)

Model	SCT-2SP	SCT-3SP	SCT-4SP	SCT-6SP	SCT-8SP
Min. cross-sectional area	12	34	54	103	225

Flow Rate – Pressure Loss Characteristics

[Test conditions] • Fluid : Water • Temperature : 23°C ± 3°C

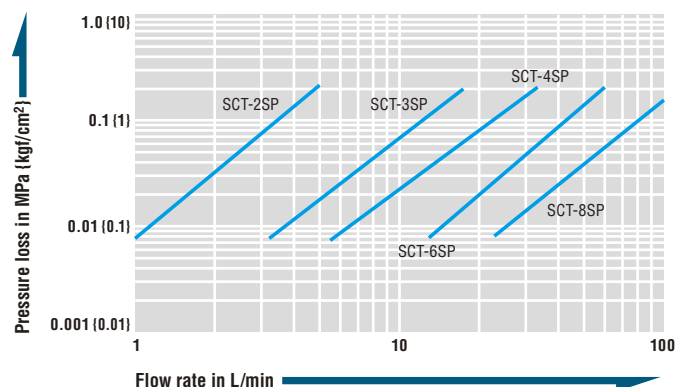

Interchangeability

Different sizes are not interchangeable.

Models and Dimensions

WAF : WAF stands for width across flats.

Plug

Female thread

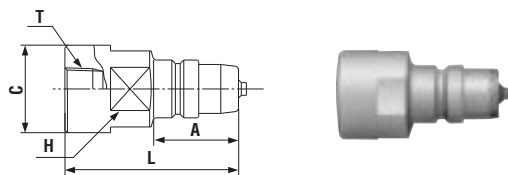

Model	Mass (g)	Dimensions (mm)				
		L	A	ØC	H(WAF)	T(Female thread)
SCT-2P	43	59	30.5	27.5	24	Rc 1/4
SCT-2P-NPT						1/4-18NPT
SCT-3P	77	68.5	33.5	34.5	30	Rc 3/8
SCT-3P-NPT						3/8-18NPT
SCT-4P	91	69.5	37.5	39.5	36	Rc 1/2
SCT-4P-NPT						1/2-14NPT
SCT-6P	160	78.5	45	48	41	Rc 3/4
SCT-6P-NPT						3/4-14NPT
SCT-8P	300	112	60.5	59	50	Rc 1
SCT-8P-NPT						1-11.5NPT

* Available end configurations are female ISO Rc thread and female NPT thread.

* Plug or socket with female ISO Rc end configuration has V-groove on the body as identification. (In case of female NPT thread, no V-groove on either plug or socket body).

* Please inquire for other end configurations other than female thread (e.g. flanged or male thread).

Socket

Female thread

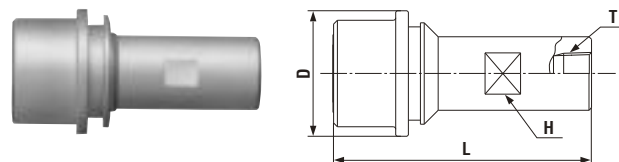

Model	Mass (g)	Dimensions (mm)			
		L	ØD	H(WAF)	T(Female thread)
SCT-2S	101	89.5	41	19	Rc 1/4
SCT-2S-NPT					1/4-18NPT
SCT-3S	156	102	49.5	24	Rc 3/8
SCT-3S-NPT					3/8-18NPT
SCT-4S	192	107	54.5	30	Rc 1/2
SCT-4S-NPT					1/2-14NPT
SCT-6S	340	123	68	36	Rc 3/4
SCT-6S-NPT					3/4-14NPT
SCT-8S	770	172.5	82	46	Rc 1
SCT-8S-NPT					1-11.5NPT

Before use, please be sure to read "Safety Guide" described at the end of this book and "Instruction Sheet" that comes with the products.