

Design to use Jetbroach and Hi-broach Annular Cutters



ATRA ACE
Manual feed
Model **AO-5575**

MAX. 55mm dia. x 75mm deep
LIGHT WEIGHT 18kg

Coolant Valve
Adjustable coolant flow delivered to the center of the cutter.



Optional Chip Breaker
This chip breaker prevents the cutter from becoming jammed with metal shavings.

Built-in coolant tank prevents damage



Reversible feed handle



Speed selection (Change gear)

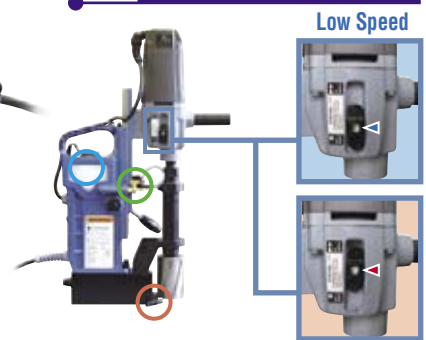

Low Speed

Hi Speed

Specifications

Model		AO-5575		
Power Source (Single Phase)		220~240 V AC 50/60Hz		
Electric Drill	Rated Power Consumption	W	1,150	
	Rated Current	A	5.4	
	No Load Speed	min ⁻¹ (rpm)	350 / 650	
Magnet Power Consumption		W	50	
Hole-cutting Capacity		Cutter	Hole Diameter	Plate Thickness
One-touch type JETBROACH			MAX. 55 mm	MAX. 75 mm
One-touch type HI-BROACH			MAX. 50 mm	MAX. 50 mm
Magnet Holding Power	kN (kgf)	10 (1,020)		
Magnet Dimensions	mm	86 x 170		
Mass (Weight)	kg	18		
Standard Accessories		<ul style="list-style-type: none"> Pilot Pin 08050 A3 : 1 pc. 3 mm Hex Socket Screw Key : 1 pc. Cutting Oil 0.5 ℓ : 1 can Chain Assy : 1 set 5 mm Hex Socket Screw Key : 1 pc. Guard Assy : 1 set Side Hand Assy : 1 set 8 x 10 mm Spanner : 1 pc. 		
Optional Accessories		<p>Always use genuine Nitto Kohki cutters & coolant.</p> <ul style="list-style-type: none"> JETBROACH One-touch Type 35mm, 50mm, 75mm HI-BROACH One-touch Type 25mm, 50mm T801507 Cutting Oil 2 ℓ per can 		



Load detector with "Smart-Stop/Rapid-Restart" technology

As the drilling load increases, the load indicator will change in color from green to orange to red. In addition, if excessive feeding force is applied, the load indicator will rapidly blink red and the rotation of the drill motor will slow down and temporarily stop. If the load is released while the load indicator is blinking red, the drill motor will resume its rotation.

LED load indicator



Slow Blinking Green

Drill motor will not turn on

Drill motor shuts off

"Rapid-Start" resumes drilling operation

Resume proper load

Safety mode

Magnet malfunction



Slow Blinking Red

One-touch cutter replacement

Our original self-centering tool-less chuck is quick and easy to change cutters with little downtime.

(WOJ-3200)

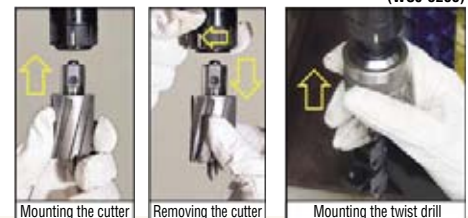

Mounting the cutter

Removing the cutter

Mounting the twist drill